

PROJECTION SCREEN INSTALLATION GUIDE

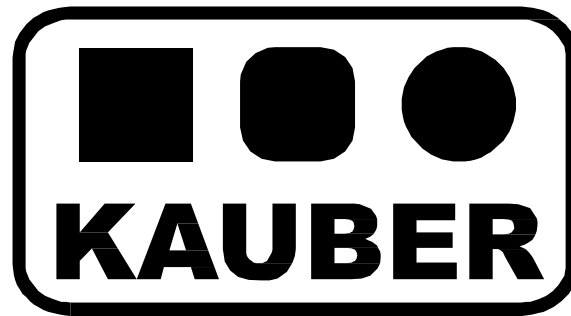

WHITE LABEL



White Label is a series of electric projection screens in aluminum casings. This series has been designed for offices, as well as conference and lecture halls. A very small, elegant housing will fit into any office and conference space.

IMPORTANT!!!
INSTALLATION AND OPERATION NOTES

1. The screen should be installed in a location away from moisture and strong sunlight.
2. A properly mounted screen must be absolutely levelled.
3. Use a soft, moistened cloth for cleaning. Do not use active cleaners. Protect the screen from ingress of water or other liquid inside. After cleaning, the screen should be carefully wiped to remove any residual moisture.
4. **DIMENSIONAL TOLERANCE:** Projection surface: $\pm 5\text{mm}$; components $\pm 3\text{mm}$
5. The screen / elevator cannot have connected more than one remote control at once.
6. One remote control (for ex. RC01 / RC02 / Trigger 12V / Trigger230V / IR Receiver / RS Receiver, etc.) cannot be connected at once to more than one screen, elevator, roller-blind, etc. Such connection can only be made by using the SG-2 group controller.

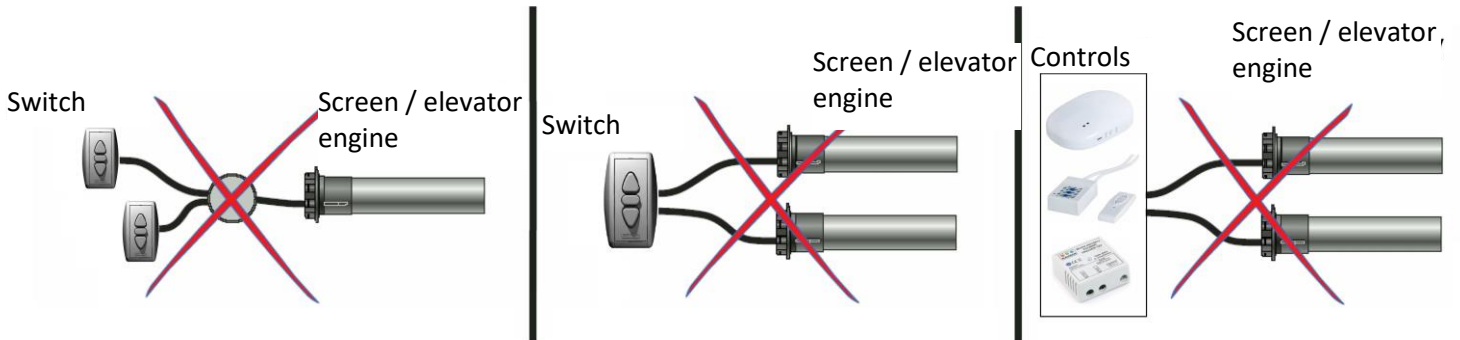

Package contents:	Qty.
Projection screen	1 pcs
Mounting bracket	2 pcs
Screws for the bracket	8 pcs
Expansion dowel Ø10	4 pcs
M6 washer	4 pcs
Wrench for adjusting the end positions of the screen	1 pcs
Wall key switch (available for screen without a built-in radio control)	1 pcs

SCREEN INSTALLATION

1. Using the screws (c), attach mounting brackets to the sides of the screen (a) depending on the mounting method (b) in the wall position (fig. 1a) or ceiling one (fig.1b)

Wall mounting

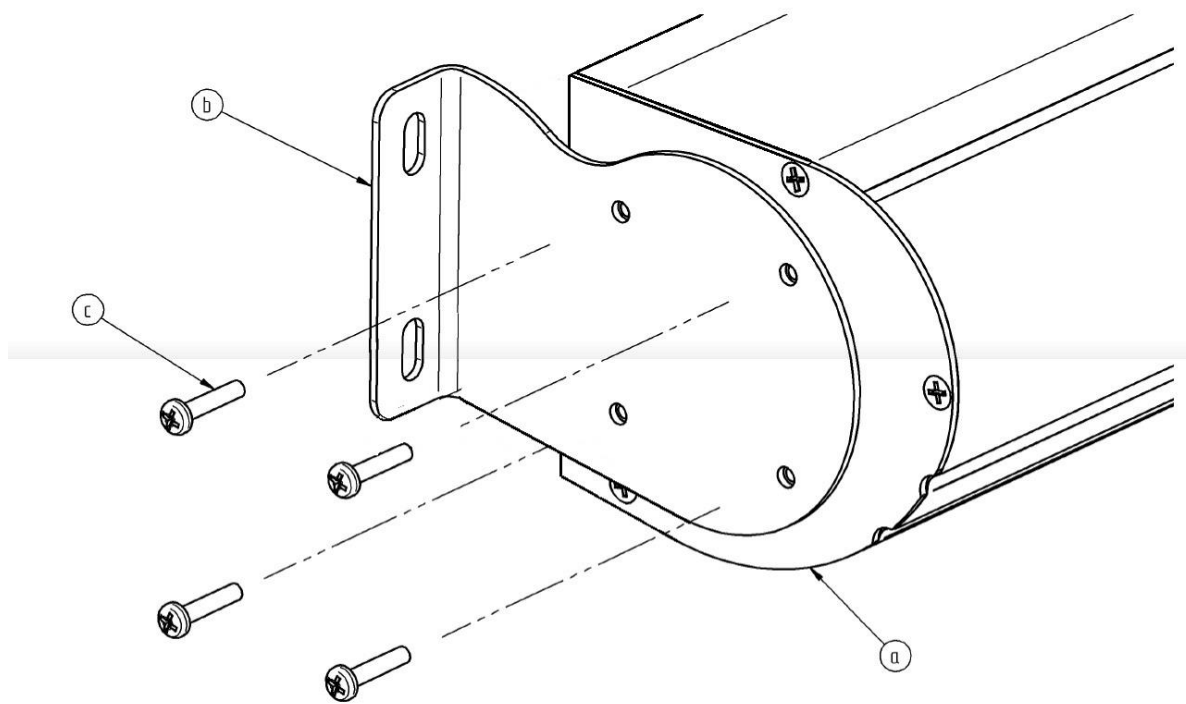

Fig.1a

Ceiling mounting

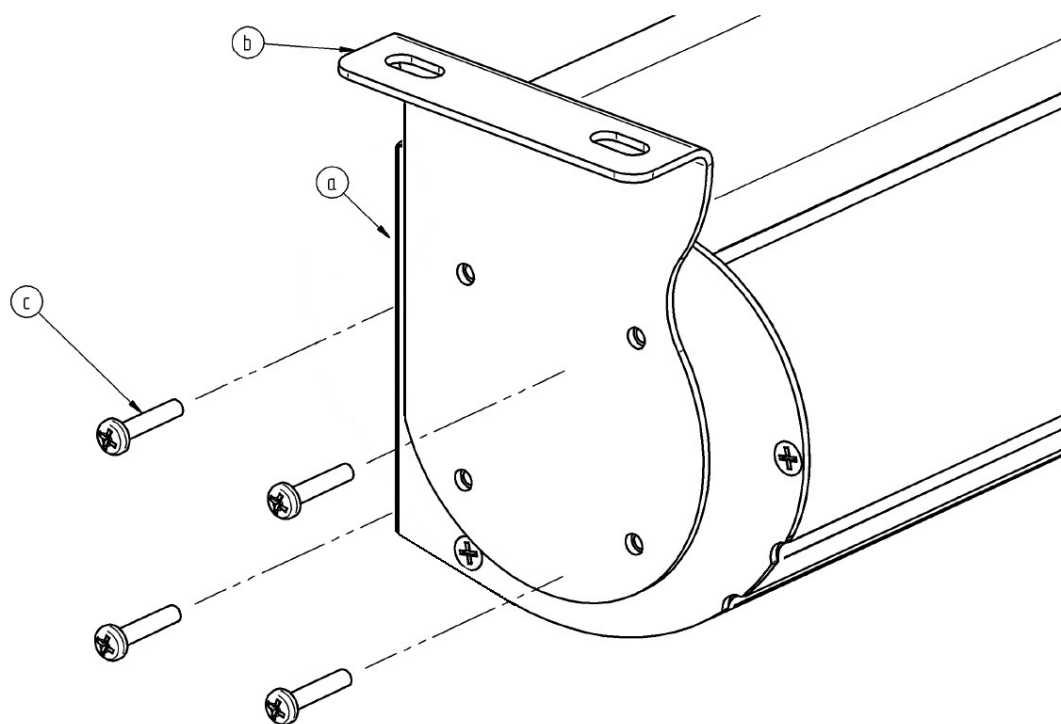

Fig.1b

2. Depending on the method of mounting, screw the mounting brackets using the mounting dowels to the wall (Fig.2a) or to the ceiling (Fig.2b).

NOTE! The mounting dowels provided in the set can be used only for ceilings and walls made of solid materials (for ex. concrete, suporex). When attaching the screen to materials other than those listed, choose appropriate mounting dowels.

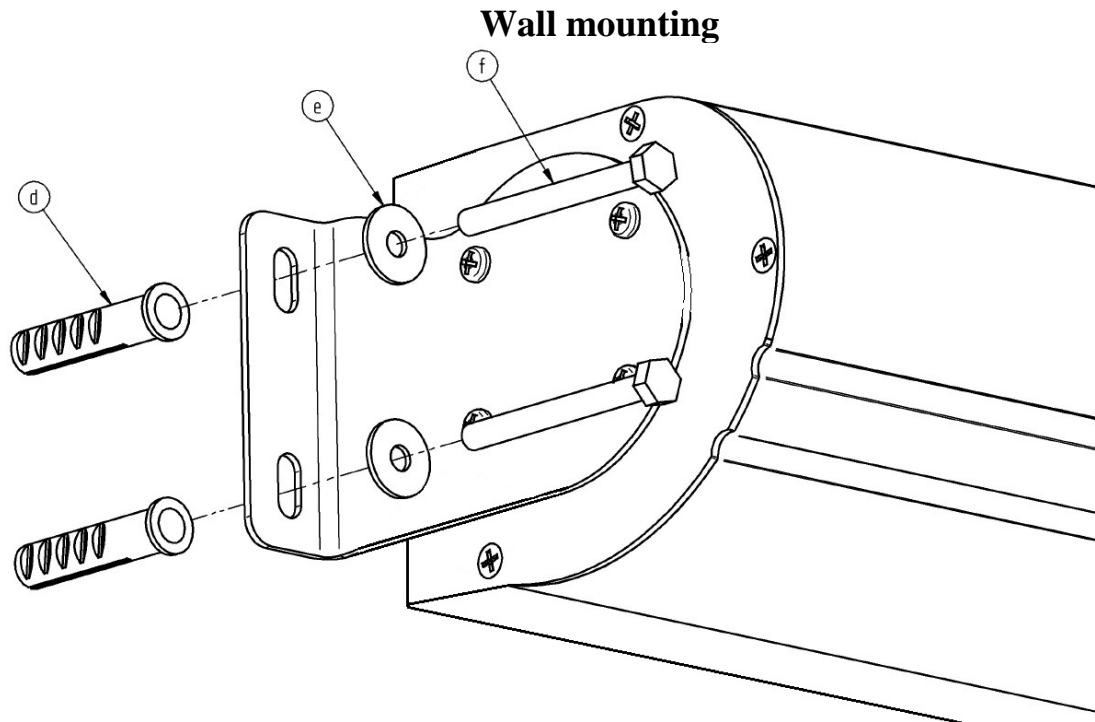

Fig.2a

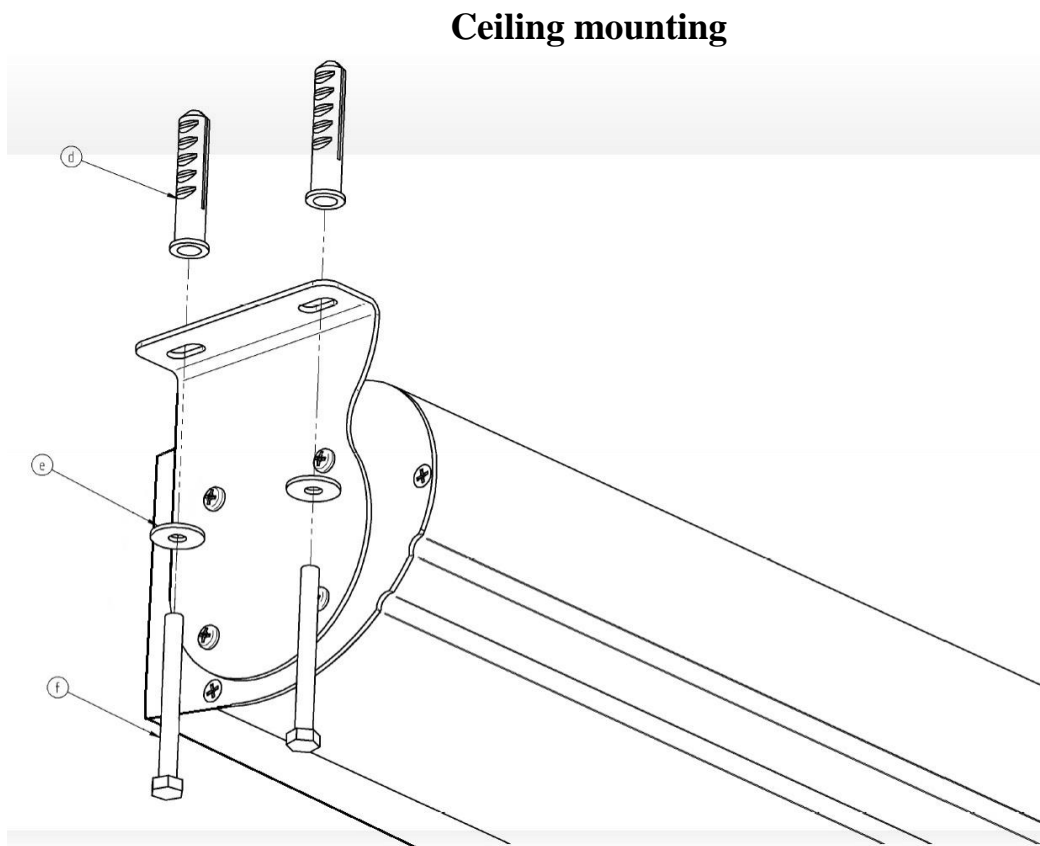

Fig.2b

3. The delivered screen has end positions set in accordance with the order. If the surface of the screen scrolls too low or not enough, correct the bottom end position using the included wrench (fig.3). **Before adjustment, check in the warranty card which type of engine your screen is equipped with.**

NOTE! Adjustments to the end positions can only be made by a qualified person. All adjustments are made at your own risk. In the event of an inaccurate adjustment, the screen may get damaged, which is not covered by the terms of the warranty.

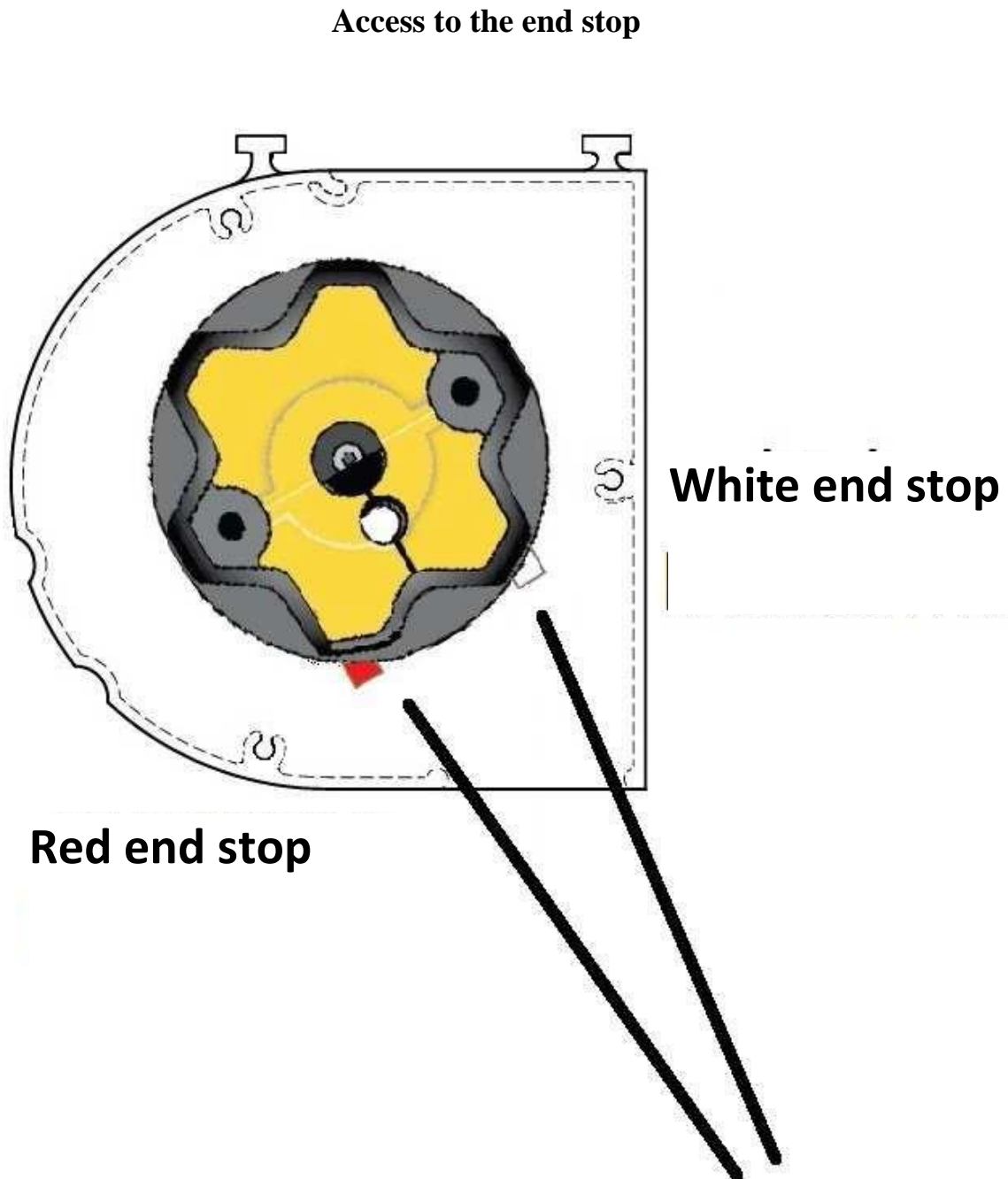

Fig.3

Adjusting the end positions (engine type "A" and "A-RTS" - check the engine type in warranty card)

- Correcting the top end position (white end stop).

Fig.4

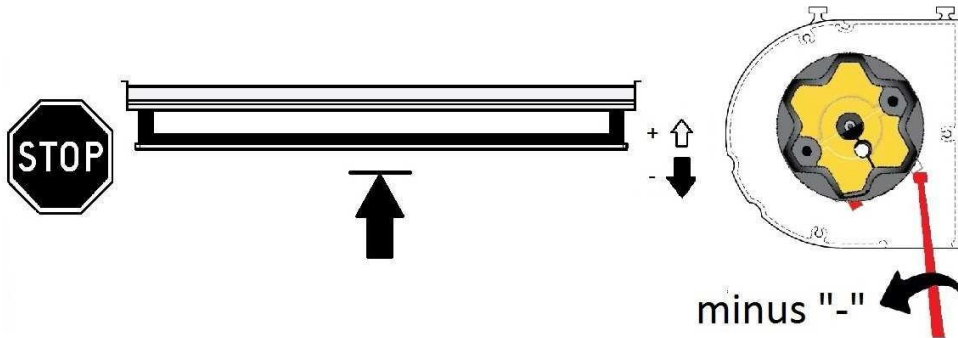
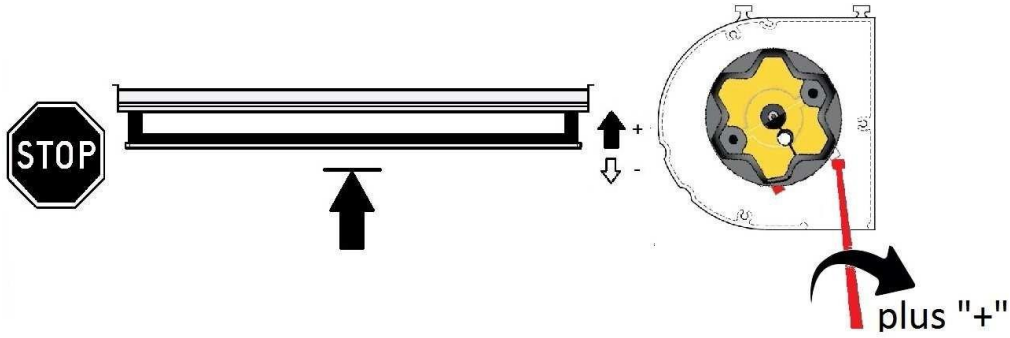

Fig.5

- Correcting the bottom end position (red end stop).

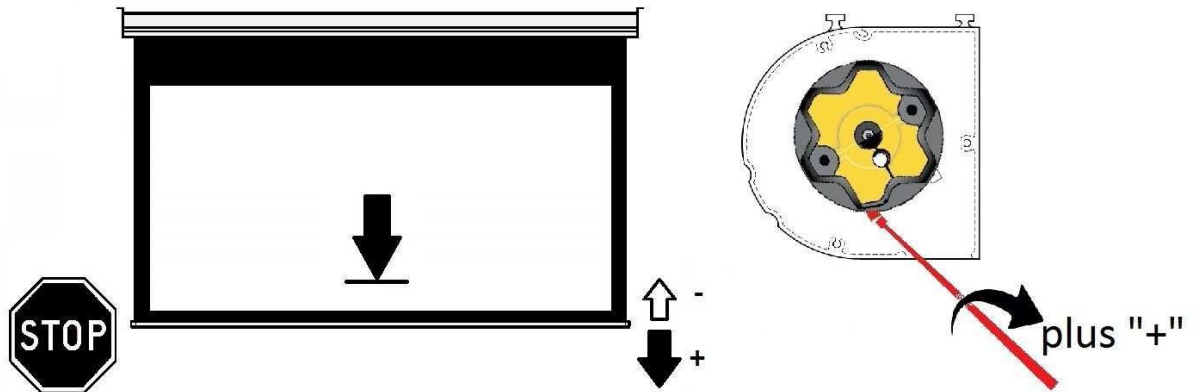

Fig.6

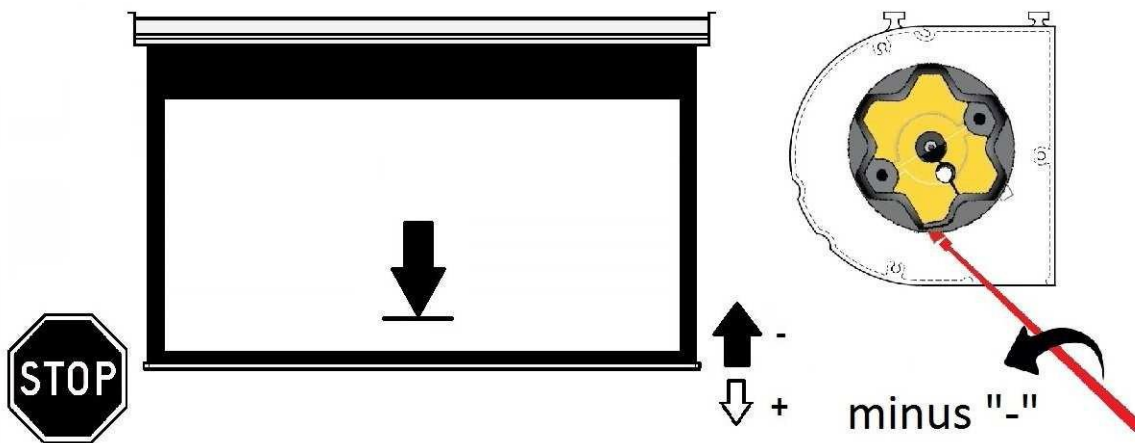

Fig.7

NOTE!

The screen may only be connected to the power supply by a person with appropriate electrical qualifications.

Before installing the screen cassette, lead the power supply cable to the place of installation and then connect it to the screen during installation according to the diagram **A (Fig.8A)** or according to the diagram **B** in the case of a screen with built-in radio control (**Fig.8B**).

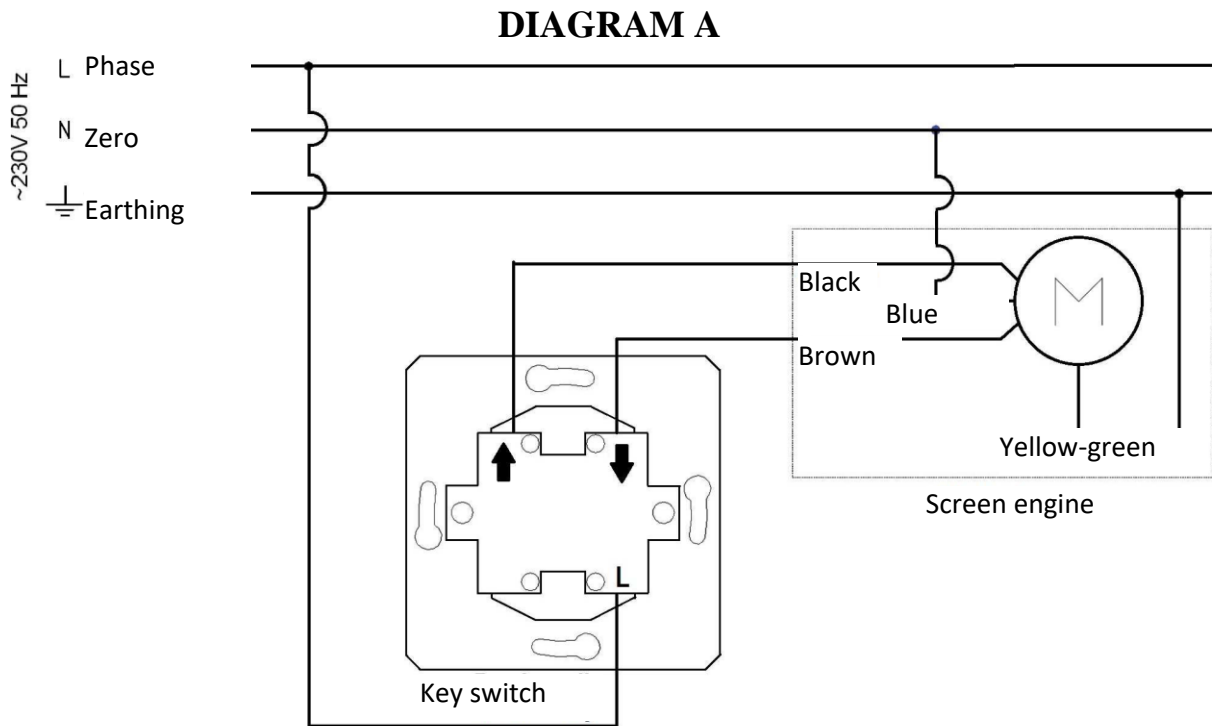

Fig. 8A

DIAGRAM B (built-in radio control)

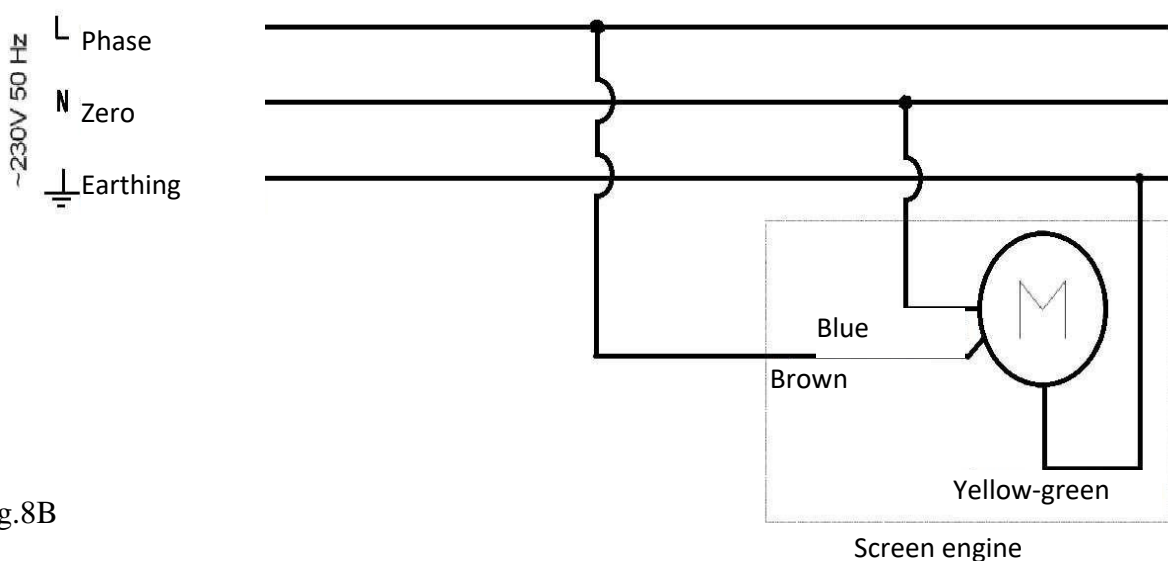

Fig.8B

Connecting a key switch from the set.

(The switch is available in the set for screen without a built-in radio control)

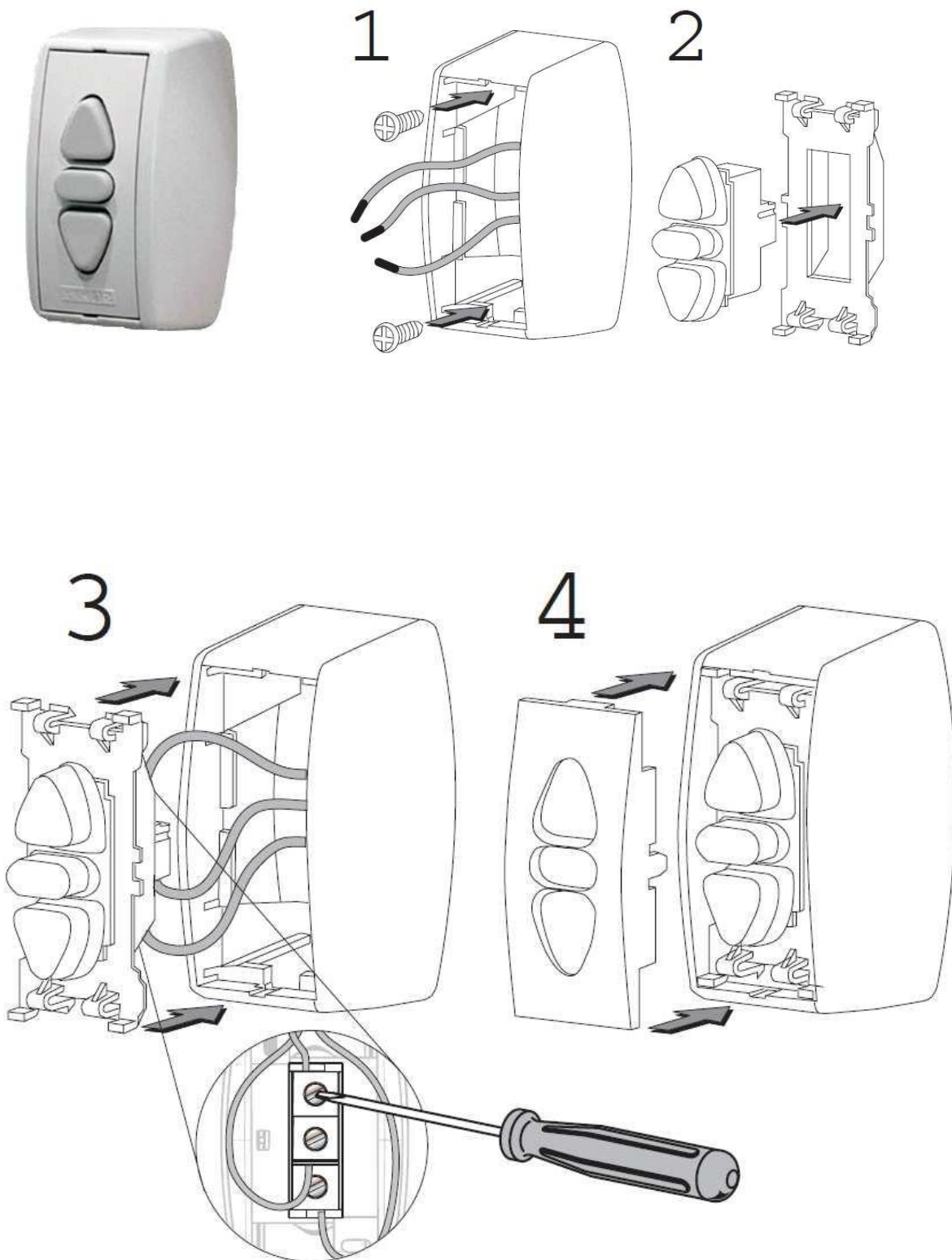

Fig.9

Diagram of connecting a key switch to the screen (screens with an "A" type engine)

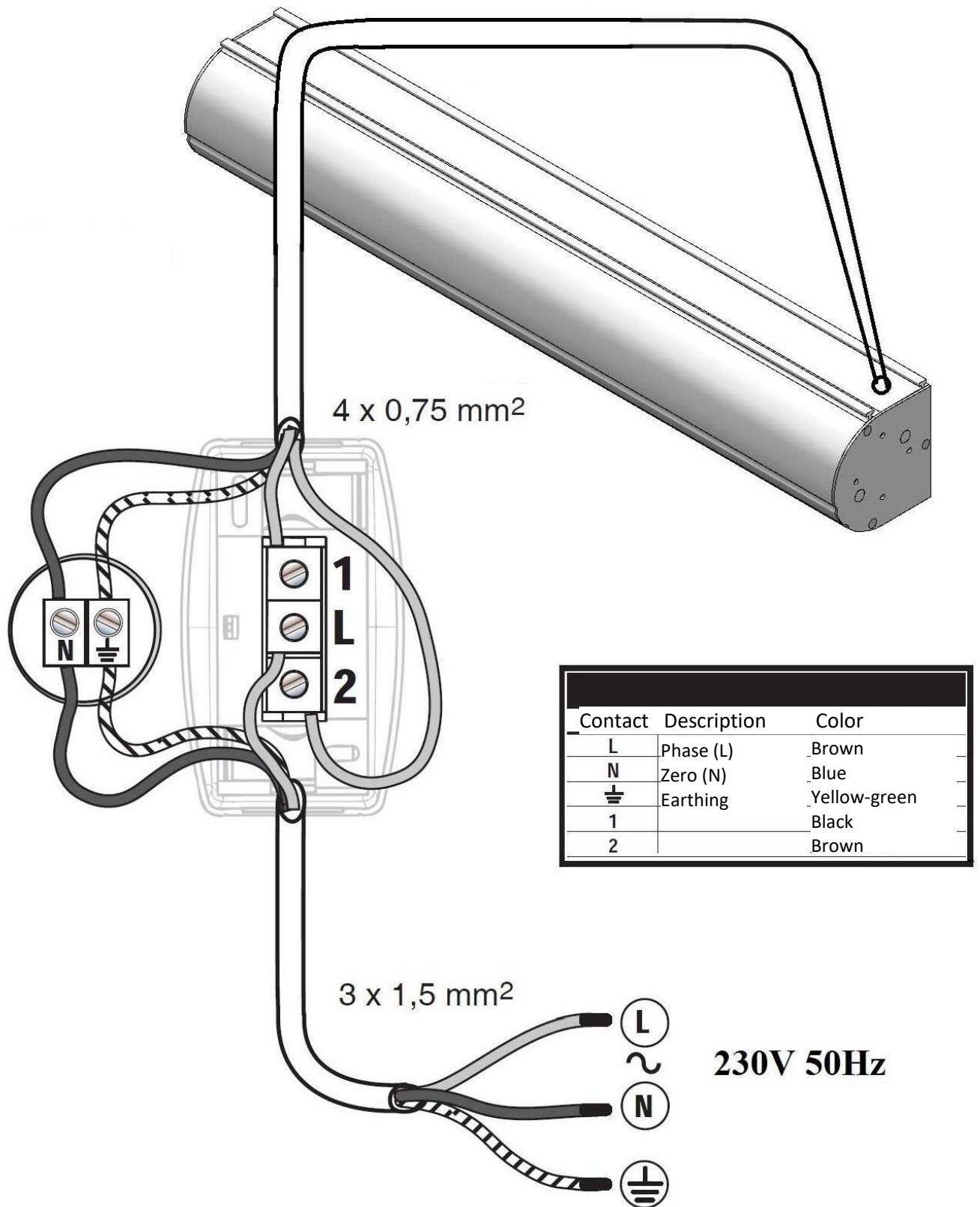
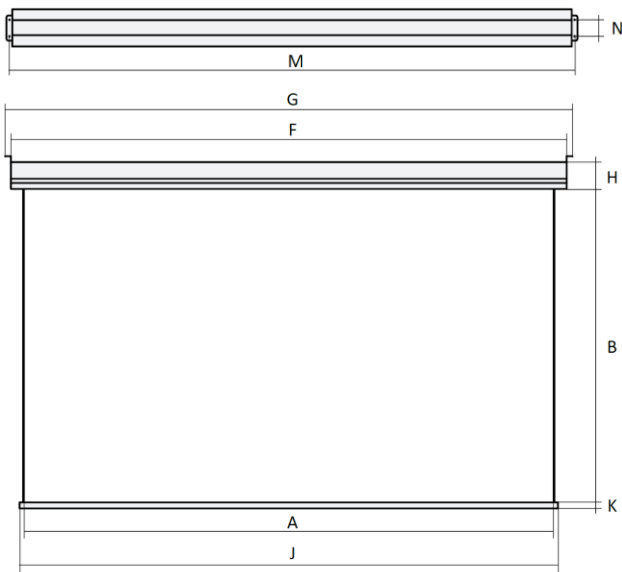
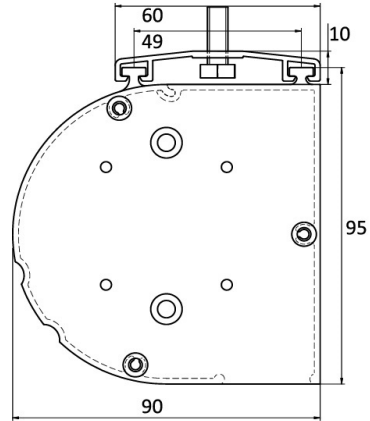
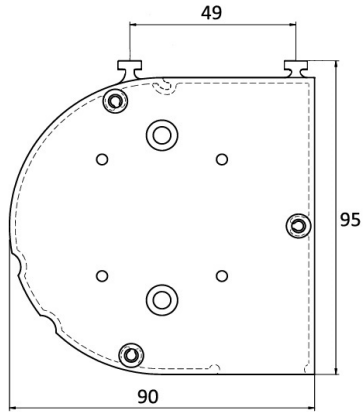

Fig.10

TECHNICAL DATA

Housing dimensions:



WHITE LABEL
 A- surface width
 B- surface height
 $F = A + 64\text{mm}$
 $J = A + 30\text{mm}$
 $K = 25\text{mm}$
 $H = 95\text{mm}$
 $G = A + 110\text{mm}$
 $M = A + 90\text{mm}$
 $N = 35\text{mm}$

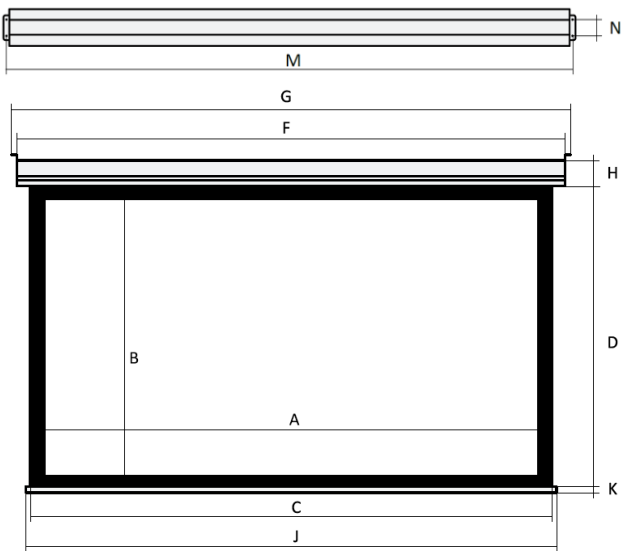

WHITE LABEL + BLACK FRAME
 A- width of active surface
 B - height of active surface
 $C = A + 100\text{mm}$
 $D = B + 100\text{mm}$
 $F = A + 164\text{mm}$
 $J = A + 130\text{mm}$
 $K = 25\text{mm}$
 $H = 95\text{mm}$
 $G = A + 210\text{mm}$
 $M = A + 190\text{mm}$
 $N = 35\text{mm}$

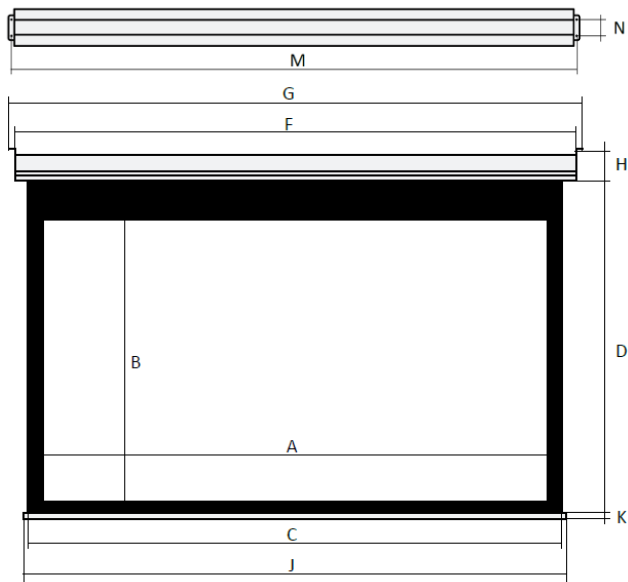

WHITE LABEL + BLACK FRAME +
 BLACK STRIP
 A- width of active surface
 B - height of active surface
 $C = A + 100\text{mm}$
 $D = B + 50\text{mm} + \text{height of the black strip}$
 $F = A + 164\text{mm}$
 $J = A + 130\text{mm}$
 $K = 25\text{mm}$
 $H = 95\text{mm}$
 $G = A + 210\text{mm}$
 $M = A + 190\text{mm}$
 $N = 35\text{mm}$

Technical specifications:

Power supply: 230V 50Hz

Power: 120W – screen without a built-in radio control
 120W – screen with built-in radio control

Thank you for choosing the KAUBER screen.
 We invite you to purchase other KAUBER products

w w w . k a u b e r . e u